

► **Features**

- **Connection system:** screw-on
- **Disconnection system:** screw-on
- **Shut off system:** flat valve
- **Connectability:** both male and female couplings under residual pressure
- **Disconnection under pressure:** allowed
- **Interchangeability:** worldwide market
- Screw-on latching system
- Standard seals in Neoprene or HNBR (Hydrogenated NBR)
- Arranged for bulkhead mounting
- Wide range of brazed and threaded adaptors
- Also available in Brass (see at page 12)
- Also available with copper-sweat connections (see at page 14)
- Special versions available on request
- **UL Listed: File N° SA13163 (all sizes except 06)**
- UL marking on request



► **Technical data**

Size ❖	DN Nominal diameter	mm	
		mm	inc.
1/4"	04	5	0.20
3/8"	06	7	0.28
1/2"	08	9	0.35
3/4"	12	16	0.63
1"	16	25	0.98
1-1/2"	24	35	1.38

Minimum burst pressure					
Connected		Male		Female	
MPa	PSI	MPa	PSI	MPa	PSI
100	14500	53	7685	10,5	1523
70	10150	24	3480	19	2755
55	7975	55	7975	8,3	1204
43	6235	43	6235	10,5	1523
37	5365	12	1740	7,5	1088
30	4350	16	2320	11,5	1668

Air inclusion and fluid loss	Maximum leakage rate * *	Vacuum rating		Connection sleeve torque
cc max.	g/year	mmHg	incHg	Nm
0,02	1,5	2	0,08	8 ⁺² ₋₀
0,05	1,5	2	0,08	30 ⁺⁵ ₋₀
0,1	1,5	2	0,08	50 ⁺⁵ ₋₀
0,1	1,5	2	0,08	60 ⁺⁵ ₋₀
0,2	1,5	2	0,08	80 ⁺¹⁰ ₋₀
0,2	1,5	2*	0,08*	80 ⁺¹⁰ ₋₀

*Connected

Size ❖	DN Nominal diameter	mm	
		mm	inc.
1/4"	04	5	0.20
3/8"	06	7	0.28
1/2"	08	9	0.35
3/4"	12	16	0.63
1"	16	25	0.98
1-1/2"	24	35	1.38

Maximum working pressure *					
Connected		Male		Female	
MPa	PSI	MPa	PSI	MPa	PSI
33	4785	17,5	2538	3,5	508
23,3	3379	8	1160	6	870
18,3	2654	18,3	2654	2,75	400
14,3	2074	14,3	2074	3,5	508
12,3	1784	4	580	2,5	363
10	1450	5,3	769	3,8	551

* Safety factor = 1:3 - For static pressure safety factor 1:2

** R22 equivalent refrigerant, at operating range, both connected and disconnected.

Materials:

- Male, female and valves in steel.
- Surface treatment: zinc plating with Cr III passivation.
- Springs in stainless steel.

Seals: standard in Neoprene or HNBR.

On request: EPDM, Viton or other seals.

Working temperatures:

With Neoprene seals from -40°C (-40°F) to +120°C (+248°F).

With HNBR seals from -25°C (-13°F) to +140°C (+284°F).

Temperatures refer to theoretical working conditions in laboratory.

► **Pressure drop chart**

See at page 21

► **Installation and Brazing instructions**

See at pages 22-23-24

► **Accessories - Spare part kit**

See at pages 19-20

► **Seals compatibility**

See at page 24

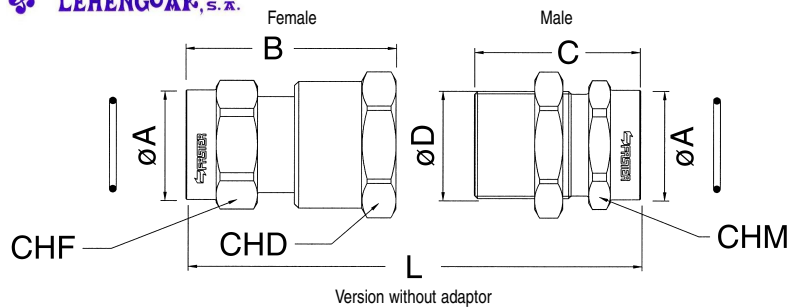

Version without adaptor	❖	Female	Male	Ø A	Seals material	B		C		Ø D mm	CHD		L		CHF		CHM	
						mm	inc.	mm	inc.		mm	inc.	mm	inc.	mm	inc.	mm	inc.
04		RF 04 F N	RF 04 M N	1/2" - 20 UNF	Neoprene	28	1,10	27,5	1,08	5/8" - 18 UNF	19	0,75	48,5	1,91	16	0,63	19	0,75
		RF 04 F H	RF 04 M H	1/2" - 20 UNF	HNBR	28	1,10	27,5	1,08	5/8" - 18 UNF	19	0,75	48,5	1,91	16	0,63	19	0,75
		*RF 04 F E	*RF 04 M E	1/2" - 20 UNF	EPDM	28	1,10	27,5	1,08	5/8" - 18 UNF	19	0,75	48,5	1,91	16	0,63	19	0,75
		RF 04 F V	RF 04 M V	1/2" - 20 UNF	Viton	28	1,10	27,5	1,08	5/8" - 18 UNF	19	0,75	48,5	1,91	16	0,63	19	0,75
06		*RF 06 F N	*RF 06 M N	M18x1,5	Neoprene	34,8	1,37	27	1,06	M20x1,5	24	0,94	53	2,09	22	0,87	22	0,87
		*RF 06 F H	*RF 06 M H	M18x1,5	HNBR	34,8	1,37	27	1,06	M20x1,5	24	0,94	53	2,09	22	0,87	22	0,87
		*RF 06 F E	*RF 06 M E	M18x1,5	EPDM	34,8	1,37	27	1,06	M20x1,5	24	0,94	53	2,09	22	0,87	22	0,87
08		*RF 06 F V	*RF 06 M V	M18x1,5	Viton	34,8	1,37	27	1,06	M20x1,5	24	0,94	53	2,09	22	0,87	22	0,87
		RF 08 F N	RF 08 M N	7/8" - 20 UNEF	Neoprene	46,5	1,83	38,5	1,52	1" - 20 UNEF	30	1,18	76,5	3,01	27	1,06	27	1,06
		RF 08 F H	RF 08 M H	7/8" - 20 UNEF	HNBR	46,5	1,83	38,5	1,52	1" - 20 UNEF	30	1,18	76,5	3,01	27	1,06	27	1,06
		*RF 08 F E	*RF 08 M E	7/8" - 20 UNEF	EPDM	46,5	1,83	38,5	1,52	1" - 20 UNEF	30	1,18	76,5	3,01	27	1,06	27	1,06
12		RF 08 F V	RF 08 M V	7/8" - 20 UNEF	Viton	46,5	1,83	38,5	1,52	1" - 20 UNEF	30	1,18	76,5	3,01	27	1,06	27	1,06
		RF 12 F N	RF 12 M N	1-1/4" - 18 UNEF	Neoprene	55,5	2,19	44	1,73	1-7/16" - 16 UN	41	1,61	85,5	3,37	36	1,42	41	1,61
		RF 12 F H	RF 12 M H	1-1/4" - 18 UNEF	HNBR	55,5	2,19	44	1,73	1-7/16" - 16 UN	41	1,61	85,5	3,37	36	1,42	41	1,61
		*RF 12 F E	*RF 12 M E	1-1/4" - 18 UNEF	EPDM	55,5	2,19	44	1,73	1-7/16" - 16 UN	41	1,61	85,5	3,37	36	1,42	41	1,61
16		*RF 12 F V	*RF 12 M V	1-1/4" - 18 UNEF	Viton	55,5	2,19	44	1,73	1-7/16" - 16 UN	41	1,61	85,5	3,37	36	1,42	41	1,61
		RF 16 F N	RF 16 M N	1-19/32" - 20 UN	Neoprene	61,5	2,42	46,5	1,83	1-3/4" - 16 UN	50	1,97	92	3,62	46	1,81	50	1,97
		*RF 16 F H	*RF 16 M H	1-19/32" - 20 UN	HNBR	61,5	2,42	46,5	1,83	1-3/4" - 16 UN	50	1,97	92	3,62	46	1,81	50	1,97
		*RF 16 F E	*RF 16 M E	1-19/32" - 20 UN	EPDM	61,5	2,42	46,5	1,83	1-3/4" - 16 UN	50	1,97	92	3,62	46	1,81	50	1,97
24		*RF 16 F V	*RF 16 M V	1-19/32" - 20 UN	Viton	61,5	2,42	46,5	1,83	1-3/4" - 16 UN	50	1,97	92	3,62	46	1,81	50	1,97
		*RF 24 F N	RF 24 M N	M61x1,5	Neoprene	96	3,78	70	2,76	M68x2	80	3,15	150	5,91	70	2,76	70	2,76
		*RF 24 F H	RF 24 M H	M61x1,5	HNBR	96	3,78	70	2,76	M68x2	80	3,15	150	5,91	70	2,76	70	2,76
		*RF 24 F E	*RF 24 M E	M61x1,5	EPDM	96	3,78	70	2,76	M68x2	80	3,15	150	5,91	70	2,76	70	2,76
	RF 24 F V	RF 24 M V	M61x1,5	Viton	96	3,78	70	2,76	M68x2	80	3,15	150	5,91	70	2,76	70	2,76	

❖ Size *On request

BRAZE TUBING ADAPTOR SUITABLE FOR RF-RFL-RFLS SERIES

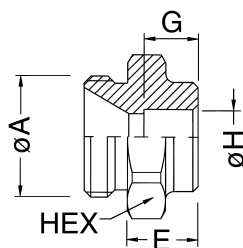

Braze tubing adaptor

Braze tubing adaptor	❖	Adaptor code	Ø A	Adaptor material	Ø H		E		G		HEX		Adaptor tightening torque Nm
					mm	inc.	mm	inc.	mm	inc.	mm	inc.	
04		RF 04 TS065	1/2" - 20 UNF	ottone	6,5	0,26	12,4	0,49	8	0,31	19	0,75	20 ⁺⁵ ₋₀
		RF 04 TS095	1/2" - 20 UNF	ottone	9,7	0,38	12,4	0,49	8	0,31	19	0,75	
06		RF 06 TS095	M18x1,5	ottone	9,7	0,38	13	0,51	8	0,31	21	0,83	25 ⁺⁵ ₋₀
		RF 06 TS125	M18x1,5	ottone	12,8	0,50	13	0,51	12	0,47	21	0,83	
08		RF 08 TS065	7/8" - 20 UNEF	ottone	6,5	0,26	13	0,51	8	0,31	27	1,06	40 ⁺⁵ ₋₀
		RF 08 TS095	7/8" - 20 UNEF	ottone	9,7	0,38	13	0,51	10	0,39	27	1,06	
		RF 08 TS125	7/8" - 20 UNEF	ottone	12,8	0,50	13	0,51	13	0,51	27	1,06	
		RF 08 TS160	7/8" - 20 UNEF	ottone	16,1	0,63	13	0,51	14	0,55	27	1,06	
12		RF 12 TS125	1-1/4" - 18 UNEF	ottone	12,8	0,50	17,5	0,69	13	0,51	36	1,42	70 ⁺¹⁰ ₋₀
		RF 12 TS160	1-1/4" - 18 UNEF	ottone	16,1	0,63	17,5	0,69	14	0,55	36	1,42	
		RF 12 TS190	1-1/4" - 18 UNEF	ottone	19,2	0,76	17,5	0,69	17	0,67	36	1,42	
		RF 12 TS220	1-1/4" - 18 UNEF	ottone	22,4	0,88	17,5	0,69	20	0,79	36	1,42	
16		RF 16 TS220	1-19/32" - 18 UN	ottone	22,4	0,88	38	1,50	20	0,79	46	1,81	90 ⁺¹⁰ ₋₀
		RF 16 TS255	1-19/32" - 18 UN	ottone	25,6	1,01	38	1,50	20	0,79	46	1,81	
		RF 16 TS290	1-19/32" - 18 UN	ottone	28,7	1,13	38	1,50	25	0,98	46	1,81	
24		RF 24 TS350	M61x1,5	ottone	35,3	1,39	46	1,81	25	0,98	70	2,75	120 ⁺¹⁰ ₋₀

❖ Size *On request

